



30 064 021-1



Impulse switch with integrated relay function IP, Matter certified ESR64PF-IPM



{REST:API}



Only skilled electricians may install this electrical equipment otherwise there is the risk of fire or electric shock!

Temperature at mounting location:
-20°C up to +50°C.
Storage temperature: -25°C up to +70°C.
Relative humidity:
annual average value < 75%.

Eltako Connect-App download:



<https://eltako.com/redirect/eltako-connect>

Impulse switch with integrated relay function IP, Matter via Wi-Fi, optionally EnOcean, 1 NO contact potential free 16 A/250 V AC, 230 V LED lamps up to 600 W, 230 V incandescent lamps and halogen lamps 2000 W. REST-API. Only 0.5 watt standby loss.

For flush mounting. 46x45mm, 20mm deep.

The connection terminals are screw terminals for conductor cross-sections of 0.2 mm² to 2.5 mm².

Supply and control voltage 12V DC or 110-240V AC.

State-of-the-art hybrid technology combines advantages of nonwearing electronic control with high capacity of special relays.

With control input for a control button or switch that may be mounted in front of it. Glow lamp current is not permitted.

This actuator is Matter certified and can therefore be paired into different ecosystems and operated in parallel.

The current setting options can be viewed via the demo mode of the ELTAKO Connect app. The range of functions can be expanded using adapters, e.g. EOA64 (EnOcean radio). Further information on this can be found on the product page of the respective adapter.

Typical connection 230 V AC

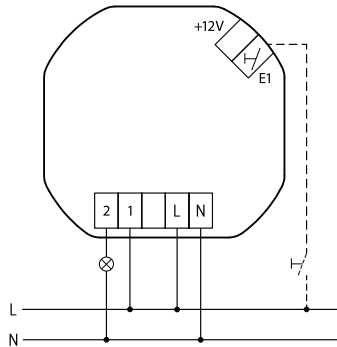

Typical connection 12 V DC

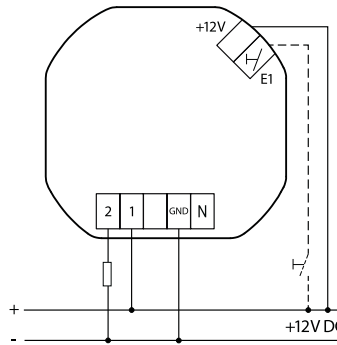

General information on commissioning:

- Only 2.4 GHz Wi-Fi frequency bands are supported.
- Recommended: Commissioning close to the main router.

Initial commissioning with Apple Home:

1. Apply mains voltage and wait for the signal tone.
2. Wait 15 seconds until the device has fully started.
3. Open the Apple Home app.
4. In the upper right corner press the '+' symbol and select 'Add device'.
5. Scan the QR code. Can be found on the rear of the device and on the QR code card in the packaging.
6. The Apple Home app will guide you through the remaining steps.

Initial commissioning with Google Home:

1. Apply mains voltage and wait for the signal tone.
2. Wait 15 seconds until the device has fully started.
3. Download and open the Google Home app.
4. Click on 'Devices' at the bottom of the screen.
5. Press '+ Add' in the bottom right corner.
6. Now click on 'New device'.
7. The Google Home app will guide you through the remaining steps.

Initial commissioning with Amazon Alexa:

1. Apply mains voltage and wait for the signal tone.
2. Wait 15 seconds until the device has fully started.
3. Download and open the Amazon Alexa app.
4. Click on 'Devices' at the bottom of the screen.
5. Press the '+' symbol in the bottom right corner and select 'Add device'.
6. Click on your automatically detected ELTAKO device.
7. The Amazon Alexa app will guide you through the remaining steps.

■ Important!

If an update is available and the device is idle, the installation will occur immediately, followed by a device restart.

Factory reset:

To confirm the reset, a signal tone sounds 3 times short and 3 times long:

Option 1:

Using the ELTAKO Connect app.

Option 2:

Connected switch/pushbutton.

1. Apply the supply voltage (time window of 5 minutes begins) press 8 times short (<1 sec.) and 1 time long (>1.5 sec. and <5 sec.).
2. A signal tone sounds for each of the last two short presses.
3. The reset is confirmed after 15 seconds. Outside of the time window, the device is simply restarted!

Option 3:

Disconnect the mains voltage.

1. Disconnect the device from the mains voltage.
2. Apply the mains voltage, wait for the signal tone and disconnect the voltage within 5 seconds.
3. Repeat the process 5 times.
4. When switched on for the 6th time, the successful reset is confirmed by 3 short and 3 long signal tones.

Over-the-Air (OTA) firmware updates:

- If the device is connected to the Internet, updates are automatically requested and installed every 12 hours, provided that no active loads are switched on.
- The data transfer between the ELTAKO update server and the device complies with the highest security standards.
- Before installation, the firmware is checked for correctness and integrity.
- **ATTENTION:** Automatic updates are carried out as long as no important processes are active and no load is switched on. The device is then restarted.
- If an update fails or leads to device instability, the system automatically switches back to the previous firmware version and waits for a new update.

Offline firmware updates:

The device also supports **offline firmware updates** via the REST API.

More information available on the product website.

Technical data

Rated switching capacity	16 A/250 V AC 8 A/12 V DC
230 V LED lamps	up to 600 W ²⁾ , I on ≤ 78 A/5 ms
Incandescent and halogen lamps ¹⁾ 230 V	2000 W
Fluorescent lamp load with KVG* in lead-lag circuit or non compensated	1000 VA
Fluorescent lamps with KVG* shunt-compensated or with EVG*	500 VA
Max. parallel capacitance (approx. length) of local control lead: (100 m)	30 nF
Standby loss (active power) with E0A64	0.5 W 0.6 W

* EVG = electronic ballast units; KVG = conventional ballast units

¹⁾ For lamps with 150 W max.

²⁾ Due to different lamp electronics and depending on the manufacturer, the maximum number of lamps may be limited, especially if the wattage of the individual lamps is very low (e.g. with 2 W LEDs).

Manuals and documents in further languages:



<https://eltako.com/redirect/ESR64PF-IPM>



Must be kept for later use!

ELTAKO GmbH

D-70736 Fellbach

Technical Support English:

☎ +49 711 943 500 25

✉ technical-support@eltako.de

eltako.com

48/2024 Subject to change without notice.